



Construction Update: Aug. 10-16, 2020
As of Friday, August 7, 2020

NOTE: All work is scheduled weather permitting, and is subject to change without notice.

CONTINUING: Triviz Drive is closed from Arrowhead Drive to Stewart Street so crews can work on the south roundabout. Also closed are the direct connections to the New Mexico State University parking lots from I-25 and north Triviz Drive.

Motorists can use Stewart Street and Arrowhead Drive to access S. Triviz Drive, University Avenue and the parking lots during this closure.

This work is expected to take about **three (3) months, lasting through early to mid-October** if there are no unforeseen circumstances.

The northbound I-25 loop ramp is **CLOSED** until further notice. Motorists can access northbound I-25 from the on-ramp.

Two lanes of traffic are open in each direction on University Avenue between Triviz and Las Alturas.

The southbound I-25 on-ramp and off-ramp will remain open until Phase 1 of the bridge construction is completed, which is currently scheduled for early November.

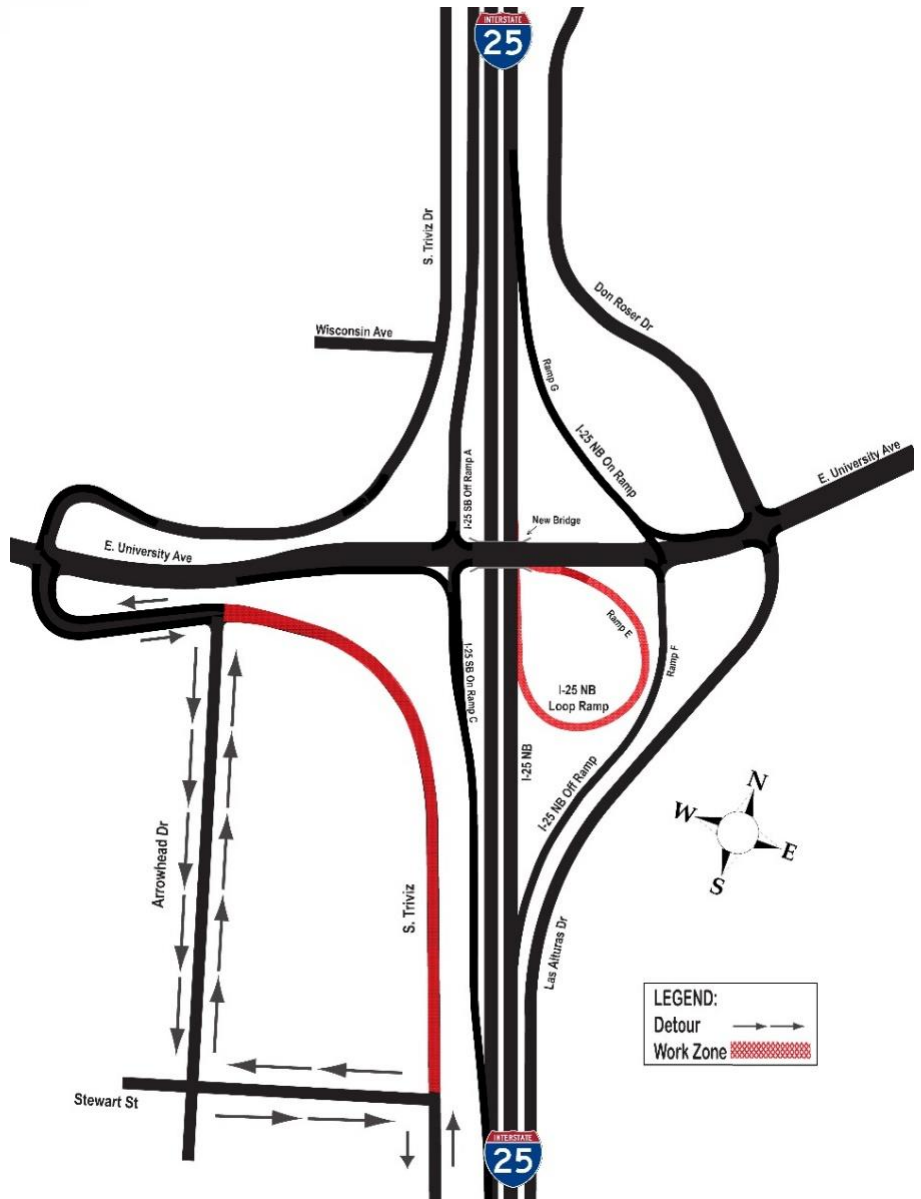

MOTORISTS SHOULD USE AN ALTERNATE ROUTE OR EXPECT DELAYS, PARTICULARLY DURING MORNING AND AFTERNOON RUSH HOURS. Thank you for your patience during construction!

Regular work hours are Monday-Friday 7 a.m.-5:30 p.m. although crews may work longer hours or weekends as needed. **Questions, Concerns:** Visit www.i25-university.com or www.nmroads.com or contact Patti Watson – pattiw@cwastrategic.com; 505-269-9691 cell.