



Construction Update: May 25-31, 2020 As of Friday, May 22, 2020

NOTE: All work is scheduled weather permitting, and is subject to change without notice.

Crews will not be working on Monday, May 25 in observance of the Memorial Day Holiday.

CONTINUING: Through about June 2, 2020, the northbound I-25 off-ramp to University Ave. is CLOSED.

I-25 northbound traffic is detoured to E. Lohman to exit I-25. Eastbound and westbound traffic on I-10 is detoured to the I-10 University exit to access University Ave.

The right lane of northbound I-25 remains closed from Geothermal Drive to the northbound I-25 loop ramp.

EXTENDED: Traffic on University Ave. between Don Roser and the northbound I-25 off-ramp is reduced to one lane in each direction (eastbound and westbound) through May 29, 2020.

The free righthand turn lane from the southbound I-25 off-ramp to westbound University Avenue is **PERMANENTLY CLOSED.** Access is provided at the traffic signal at the intersection of the ramp and University Ave.

MOTORISTS SHOULD USE AN ALTERNATE ROUTE OR EXPECT DELAYS, PARTICULARLY DURING MORNING AND AFTERNOON RUSH HOURS. *Thank you for your patience during construction!*

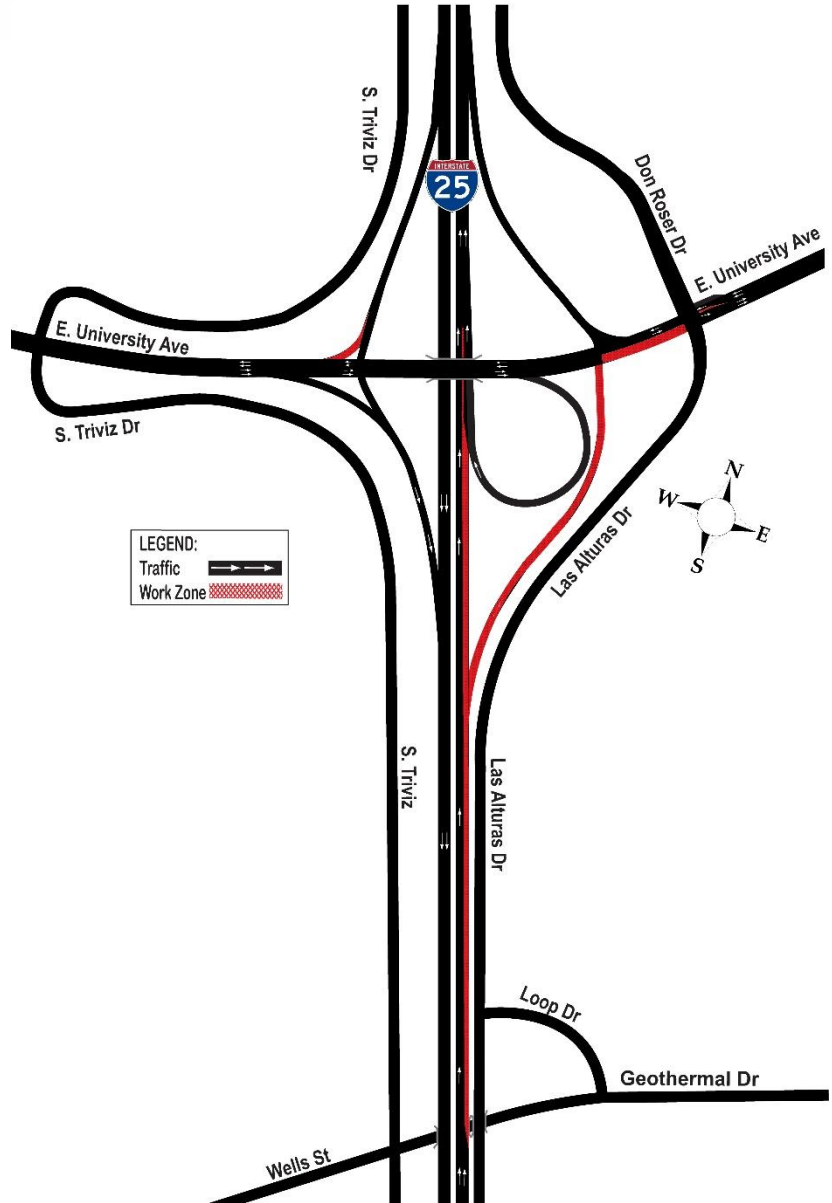

Regular work hours are Monday-Friday 7 a.m.-5:30 p.m. although crews may work longer hours or weekends as needed. Crews are scheduled to work on Saturday, May 30. **Questions, Concerns:** Visit www.i25-university.com or www.nmroads.com or contact Patti Watson – pattiw@cwastrategic.com; 505-269-9691 cell